

Main Level

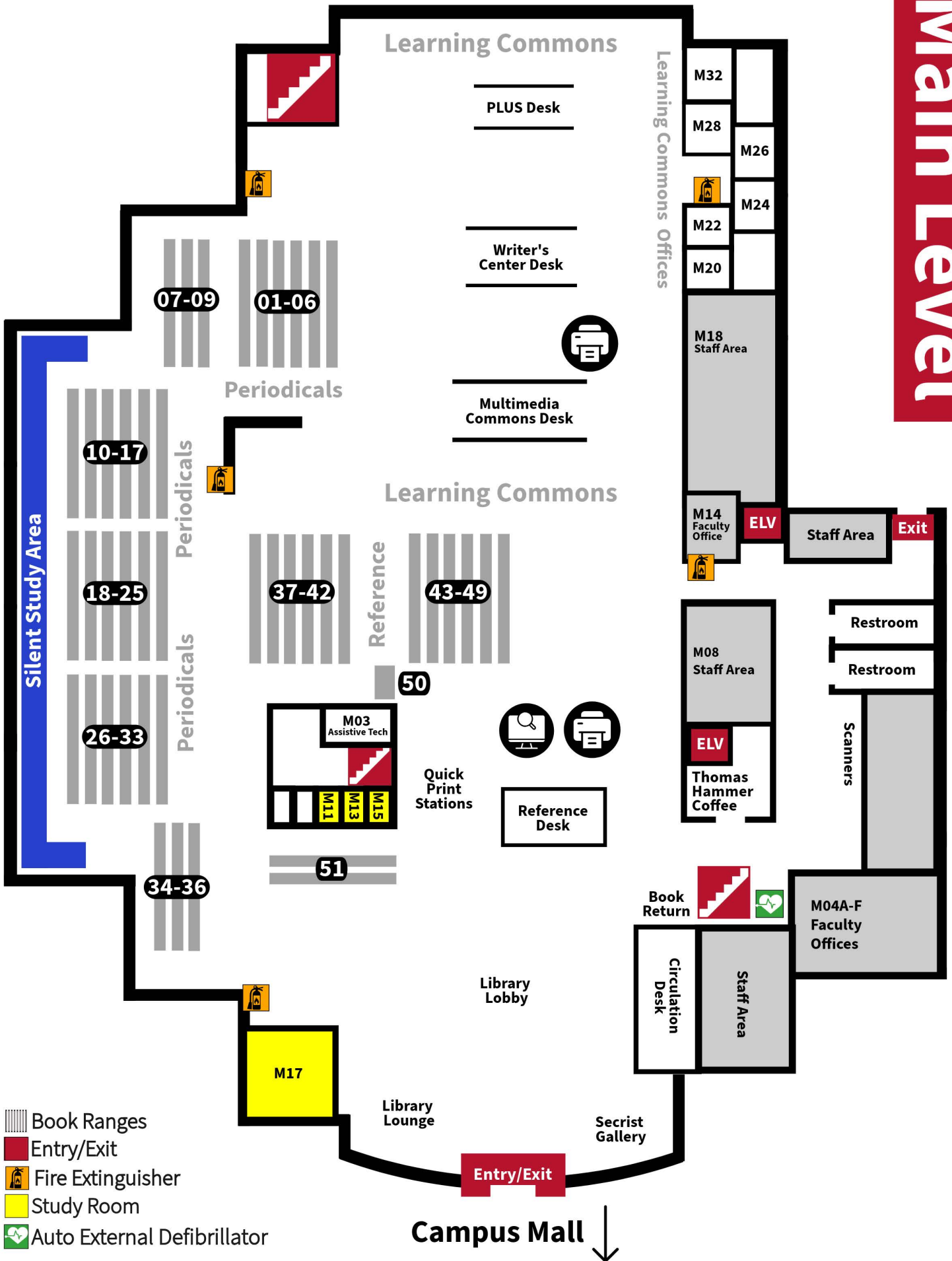

- Book Ranges
- Entry/Exit
- Fire Extinguisher
- Study Room
- Auto External Defibrillator

MAIN LEVEL CALL # SHELF #

MAIN LEVEL CALL # SHELF #

MAIN LEVEL CALL # SHELF #

PERIODICALS

Per.	AG305 - AP2	17A
Per.	AP2 - AP2	25A
Per.	AP2 - AP2	33A
Per.	AP2 - AP2	33B
Per.	AP2 - AP2	25B
Per.	AP2 - AP63	17B
Per.	AP63 - B1	16A
Per.	B1 - BF1	24A
Per.	BF1 - BF1	32A
Per.	BF1 - BF21	32B
Per.	BF21 - BF455	24B
Per.	BF455 - BX1	16B
Per.	BX1 - D410	15A
Per.	D410 - DS500	23A
Per.	DS501 - E98	31A
Per.	E99 - E184	31B
Per.	E184 - F591	23B
Per.	F591 - G1	15B
Per.	G1 - GC1	14A
Per.	GC1 - GV199.5	22A
Per.	GV199.6 - GV1580	30A
Per.	GV1580 - H1	30B
Per.	H1 - HB1	22B
Per.	HB1 - HC411	14B
Per.	HC411 - HD2346	13A
Per.	HD2346 - HF1101	21A
Per.	HF1101 - HF5001	29A
Per.	HF5001 - HF5419	29B
Per.	HF5419 - HF5601	21B
Per.	HF5601 - HF5801	13B
Per.	HG11 - HM251	9A
Per.	HM251 - HQ1101	12A
Per.	HQ1101 - HT390	20A
Per.	HT390 - HV1	28A
Per.	HV1 - HV6001	36A
Per.	HV6001 - JF1051	36B
Per.	JF1051 - JK1	28B
Per.	JK1 - K1	20B
Per.	K1 - L11	12B
Per.	L11 - L11	9B

PERIODICALS

Per.	L11 - LB1051	8A
Per.	LB1051 - LB2343	11A
Per.	LB2343 - LC3991	19A
Per.	LC3991 - ML1	27A
Per.	ML1 - ML27	35A
Per.	ML27 - N1	35B
Per.	N1 - NA1	27B
Per.	NA1 - NA9182	19B
Per.	NA9183 - P120	11B
Per.	P129 - PG3199	8B
Per.	PG3199 - PN2309	7A
Per.	PN2309 - PQ7081	10A
Per.	PQ7081 - PS1	18A
Per.	PS1 - PS508	26A
Per.	PS508 - Q1	34A
Per.	Q1 - QA1	34B
Per.	QA1 - QA1	26B
Per.	QA1 - QA76.27	18B
Per.	QA76.29 - QB1	10B
Per.	QB1 - QC1	7B
Per.	QC1 - QC1	6A
Per.	QC1 - QC176	6B
Per.	QC176 - QC770	5A
Per.	QC770 - QD1	5B
Per.	QD1 - QD1	4A
Per.	QD1 - QD241	4B
Per.	QD241 - QE1	3A
Per.	QE1 - QH1	3B
Per.	QH1 - QH301	2A
Per.	QH301 - QK1	2B
Per.	QK1 - QL785	1A
Per.	QL785 - QP1	1B

REFERENCE

Ref.	AE1 - AI21	38B
Ref.	AI21 - CE58	39A
Ref.	CE59 - DC147	39B
Ref.	DC147 - E180	40A
Ref.	E180 - GB400	40B
Ref.	GB400 - HB501	41A
Ref.	HB501 - HG4921	41B
Ref.	HG4921 - HV6001	42A
Ref.	HV6001 - JX1977	42B
Ref.	JX1977 - KF3775	43A
Ref.	KF3776 - LB17	43B
Ref.	LB17 - MT883	44A
Ref.	N1 - PD2413	44B
Ref.	PD2691 - PN761	45A
Ref.	PN761 - PN1655	45B
Ref.	PN1655 - PR1121	46A
Ref.	PR1175 - QA1	46B
Ref.	QA1 - QE460	47A
Ref.	QE461 - RC41	47B
Ref.	RC41 - TP151	48A
Ref.	TP151 - Z921	48B
Ref.	Z921 - Z1035.1	49A
Ref.	Z1035.1 - ZA4201	49B

REFERENCE U.S. GOV. DOCS

A92.53/47 - AE 2.111	37A
AE2.111 - GP3.8	37B
GP3.8 - Y4.EC7	38A

REFERENCE ATLASES

BD444 - G1115	50A
G1116 - QM451	50B

NEWSPAPERS

51A